

Specification

Operating Voltage	12/24VDC
Voltage Tolerance	±15%
Current Draw	300mA/12VDC 150mA/24VDC
Operating Temperature	-10°C~+49°C
Humidity	0~85%
Optional Bracket	CES3-LP-025, CES3-LP-050

Application Locksets

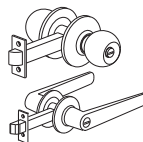

Spring latch



Latch-bolt lock

CES300 series electric strikes are designed for spring latch or lockset (e.g. cylindrical locks). The latch bolt lock comprises a latch bolt and a Nib. The CES300 electric strikes can easily be changed between fail-safe and fail-secure modes. (versions)

CES300 Hollow Metal Frames

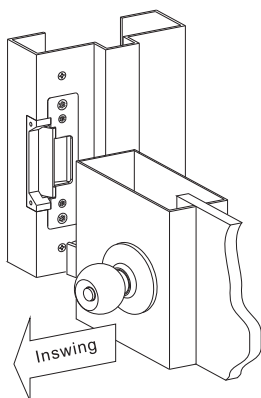

What is a Nib?

When the door is closed, the Nib makes the latch a dead bolt. The latch bolt locks into the strike keeper of the door frame to make sure that it is closed.

Electric Strike

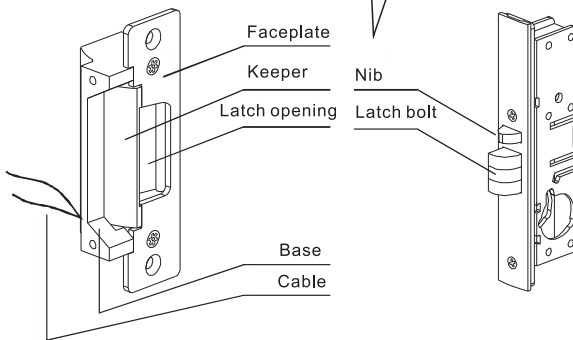

Optional Brackets

Lip extension brackets for wide jamb

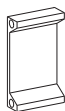

CES3-LP-050
50mm(L)



CES3-LP-025
25mm(L)

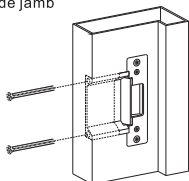

How to change Version?

Field selectable by changing position of screws

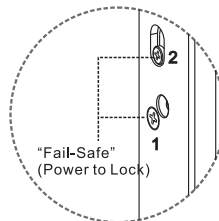
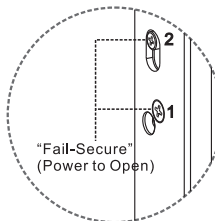

Installation Instruction

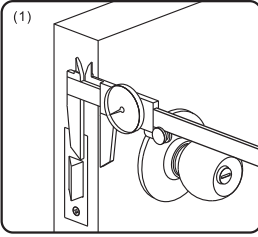

(1) Measure the latch position

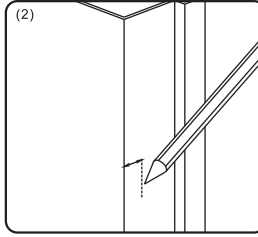

(2) Mark the latch position

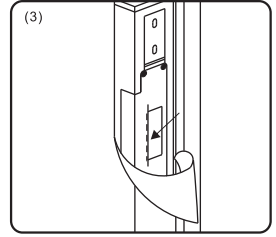

(3) Mount the supplied installation template and align to the marked line

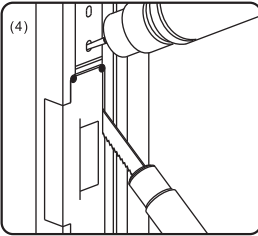

(4) Drill and cut the hole according to the template supplied

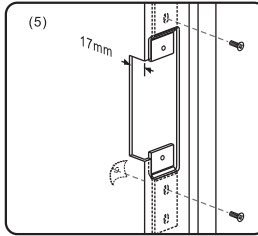

(5) Tighten the fixing plug

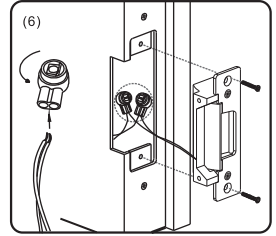

(6) Connect the power and test the unit

Caution:

Proper gap must be reserved between the strike keeper and latch bolt to prevent failure of solenoid valve.

Connecting Diagram

Dual Voltage (12V/24V)

For the 12 VDC operation, the electric strikes have to connect in parallel.

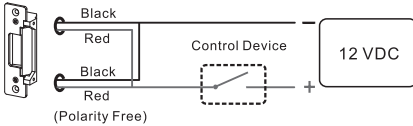

Butt Splice (IDC) Connector

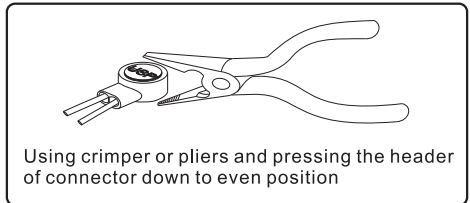

Using crimper or pliers and pressing the header of connector down to even position

For the 24 VDC operation, the electric strikes have to connect in series.

